



Building in the Spirit

**A Case Statement In Support
Of Our Plans To
Build an Education Center and Multi-Use Gymnasium/Cafeteria
and to Improve Traffic Flow and Expand Parking**

**Church of the Holy Spirit
Montgomery, Alabama**



Introduction

The history of the Church of the Holy Spirit dates back to 1977. While facilities and faces have changed somewhat over the years, one thing remains the same — our commitment to Christ, to one another, to the betterment of our community, and to learning and sharing our Catholic faith.

As a result, our parish today is an active and increasingly vibrant community comprised of over 1,000 households. Sharing our time, talent & treasure, there is an increasing number of ways that people of all ages and backgrounds are participating in the spiritual, educational, social and liturgical ministries of our parish. We are striving to live stewardship as a way of Catholic, Christian life.

Yet, despite our long history of activity and accomplishment, there are some critical challenges that remain.

Our Needs

When we planned for and completed our beautiful new church in 2001, all of our focus and resources were devoted to completion of this space. Since then, little has been done to further enhance our parish facilities and address our other needs since the new church was complete.

Early in 2003, the Long-Range Planning Committee was formed and tasked with reviewing and reporting back to the parish what we needed to plan for and build in order to accommodate all of the needs of our parish through the year 2020. This involved assessing, in depth, all of our parish's various activities and ministries as part of a more comprehensive strategic-planning process. Once this assessment was complete, McKean & Associates, an architectural firm, was hired to help us develop and prepare a Master Site Plan. This plan, approved by our Pastoral Council, was shared with all parish members in March 2007 and approved by the city of Montgomery in August 2008.

God calls us to care for and cultivate all that He has given us...not to be complacent, but rather to constantly strive to be better, to build on and improve what we have...always trying to realize our God-given potential.

Many needs surfaced from our parish surveys, and additional needs were identified by the Archbishop of Mobile when looking at the projected growth of the Catholic population in East Montgomery. The blessing of having a parish Master Site Plan for the year 2020 is knowing now where every need

will be addressed on our property. The challenge, though, is knowing that we can't do it all at once. So, several critical needs were identified to address first.

Need for Multi-Use Education and Meeting Space

Foremost among our needs at the present time is a need for additional multi-use education and meeting space on campus. The few spaces we currently have are in great demand and often not available when a group is scheduled or would like to meet. Our vibrant parish and its ministries are being held back due to this fact.

- Our kindergarten through eighth grade religious education students are currently unable to attend classes on our campus. Families are forced to travel nearly four miles to the Catholic middle school so that their children can be schooled in the precepts of our faith. This is very inconvenient for the parents. And because we must hold these classes at another facility, it prevents us from offering classes at other possibly more convenient times during the week.



- We are blessed to offer Liturgy of the Word for children during some Masses, but when we do so, we are using our only large meeting room on campus, thereby making it unavailable for other groups or ministries to use.



- Our young adult group and various adult Bible studies, classes, and ministries are often forced to meet in parish homes or are squeezed into the parish office conference room or library when they meet.
- Presently, all our meetings, classes and events must be held in the Parish Hall, Thomas Hall, the Library or the parish office conference room. With the many groups needing meeting space, this creates a scheduling nightmare, and worse, we can't always accommodate the ministries' needs and requests, which limits our parish growth.
- Our high school students are able to use the Parish Hall for Life Nights, but because there is such a need for places for small groups to meet, our youth are restricted as to when they can use this space.



Finally, with the Catholic population continuing to increase in East Montgomery, and with even more growth anticipated for the future, a need for a Catholic elementary school (K-6) was identified as part of a vision plan conducted by the Montgomery Catholic Preparatory School. The Archbishop of Mobile then, in looking at best possible locations for such a school, has asked that this elementary school be built on the Holy Spirit campus, which we as a parish and as faithful servants have embraced. The addition of the school will fulfill dual-purpose needs of our faith family by providing a Catholic education for our children (who currently are being driven across town to attend a Catholic school) while providing additional classroom meeting spaces for our many religious education classes, youth groups, adult groups and ministries.

Need for a Larger Parish Hall

In addition to more meeting spaces on campus, we also are in need of a new, larger parish hall.

- Our original worship space, home to our current Parish Hall, is a great space for meetings and dinners, but it is too small for many of the events we would like to host on campus.
- Not being able to host larger functions on campus has limited our opportunities to welcome more of our members. A larger, multi-use space would not only allow us to host larger functions, but give us much-needed flexibility in scheduling meetings and events.



Need for Improved Traffic Flow and Parking

Finally, a growing parish means additional members, which translates into increased traffic and additional cars needing adequate parking. We not only need to add additional parking spaces, we also need to improve our traffic flow into and out of our church parking lot.

- It can be a nightmare turning into the Church or leaving after busy Masses on the weekend. We need a better way to enter and exit the Church.
- In addition, our current parking lot is too small to provide enough spaces for our current members to park, much less any new members. We need to add more parking to accommodate our growing family of faith.



Our Plans

To address these critical needs, we have an exciting plan. It calls for constructing a new multi-use education facility as well as a new multi-purpose gymnasium/cafeteria which will not only serve as a recreational space for our parish adults and youth, but also as an alternative and larger space that can serve as an interim parish hall. In addition, we plan to increase the number of parking spaces, improve the traffic flow and provide a new, safer entrance/exit to our facilities.

*Just as our forefathers
and mothers sacrificed
to make our church
better, we are called to
do likewise for those
who will follow.*

New Multi-Use Education Center

We plan to construct an Education Center on our parish campus that will accommodate parish education, faith formation and parish meeting needs. This new Center will fulfill our needs well into the future and serve a dual purpose of fulfilling the mandate of the Archbishop to build an elementary school on our campus while at the same time providing us with much-needed meeting and faith formation space.

- There will be eight main level classrooms for preschool, kindergarten, first and second grade students. These rooms will be designed with age-appropriate furnishings and instructional equipment to facilitate learning.
- An additional eight second floor classrooms will be provided for third, fourth, fifth and sixth grade students. These classrooms will also have an age-appropriate setup.
- Special rooms will also be provided for a science room/lab, an art room, a computer lab, and a music room.
- All rooms will include designated storage spaces for the different groups or classes that will use the room as well as a place for the Catholic School students to store their classroom supplies, easily allowing for other students to use their desks or tables after school hours.
- All rooms will be wired for the latest in technology, too, and have the access to the latest and most effective teaching technologies and learning tools.

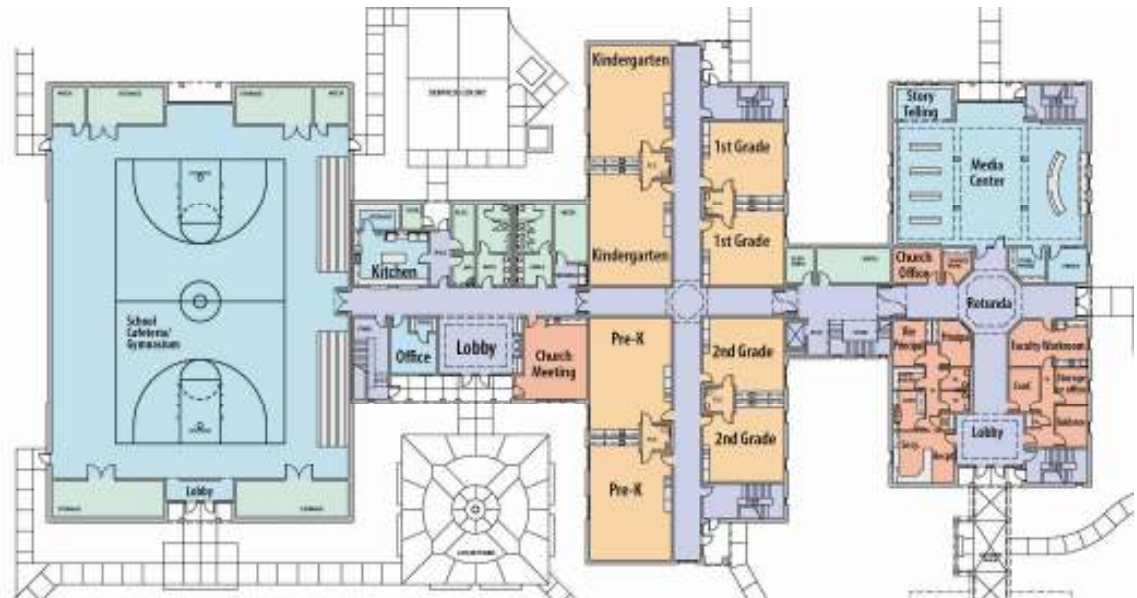

- Also included are five parish meeting rooms to accommodate a variety of adult ministry and educational meetings and events. Four of these will be located on the second floor of the building and share access to a nearby hospitality kitchenette. The fifth room will be located just off the courtyard with its own entrance to the outside. All of these spaces will have adult-sized furniture that can accommodate a variety of setup arrangements and the necessary technology equipment to serve the parish.
- This new facility will also have an energy-efficient heating and air conditioning system as well as a state-of-the-art fire detection and prevention system.
- Also included is a media center/library, including a special storytelling room.
- An administration area is included that will provide a home for the school leaders as well as an office area for the parish faith formation leaders to use. A workroom is also planned that would benefit teachers and catechists alike in preparing to teach our youth. These areas are located near the entrance and exit to provide easy parental access and to create a safe setting for our students.
- A kitchen is planned that would be able to provide a place for serving and preparing food for school lunches, fellowship snacks for classes, hospitality for adult meetings, and more.
- As an added blessing for the Parish, since this building will serve as a Catholic School, in addition to serving our parish students and adults, all the building materials will be exempt from the 10% sales tax. According to Alabama law, churches pay sales tax, but schools and their buildings are exempt from this tax.



New Cafeteria/Gymnasium

Attached to our new Education Center, we plan to build a gymnasium/cafeteria that will serve the parish as a large gathering space, as well as serve the Catholic school as a cafeteria and a space for physical education.

- The gymnasium would be on the side of the Education Center and would share a wall with the kitchen to make serving lunches or large events easier.
- Ample storage space will be provided near the gymnasium to facilitate an easy transition from table seating to open space.
- A multi-purpose floor will be installed that will allow for a great variety of uses and setups without worrying about damage to the surface.
- Also, necessary athletic equipment for the students and adult recreation leagues will be installed or available to serve the community.

Improved Traffic Flow and Expanded Parking

Finally, we plan several improvements to our roads and parking as well.

- We will relocate the main entrance and exit of the property to become opposite the Wynlakes exit, with a guarded turn lane and the possibility of a traffic light.
- The traffic pattern on campus will be redirected to better facilitate coming and going to campus and includes special drop-off areas for the Education Center.
- Parking will be relocated from its current location due to construction, but the Master Site Plan ultimately calls for having at least an additional 120 parking spaces on campus.



Our Campaign

<p>Goals</p> <p>\$3,000,000 Minimum Goal</p> <p>\$4,800,000 Challenge Goal</p> <p>\$7,400,000 Ultimate Goal</p>
--

To address our needs and plans, we are initiating an intensive fundraising effort titled the *“Building in the Spirit”* campaign. Our aim with this important effort is to raise the funds required for construction of a new multi-use Education Center, a new multi-purpose gymnasium/cafeteria, additional parking spaces, and a new, safer entrance to our facilities.

The total cost of the project is estimated at \$8.6 million. We plan on using \$1.2 million of our savings, which leaves a fundraising need of \$7.4 million. Our feasibility study completed in November of 2007 concluded we should be able to raise at least \$3 million. We set this as our minimum goal, and if we are able to achieve this, we would be able to complete all of the infrastructure along with the two-story Education Center while taking on a some debt. We need and hope to do far better

however, and have therefore set a challenge goal of \$4.8 million, that again with a reasonable amount of debt would allow us to complete the gymnasium/cafeteria in addition to the Education Center and infrastructure. Finally and an ultimate goal of \$7.4 million has been set that would allow us to complete all the work with little to no debt.

Levels of Support Needed to Succeed

In order to reach our financial objectives, we will need both a substantial number of givers and a few, fairly substantial gifts.

Ultimate Goal

Size of Gift	#	Total
\$1,000,000 or More	1	\$1,000,000
\$500,000 - \$999,999	2	\$1,000,000
\$250,000 - \$499,999	4	\$1,000,000
\$100,000 - \$249,999	10	\$1,000,000
\$50,000 - \$99,999	20	\$1,000,000
\$25,000 - \$49,999	30	\$750,000
\$10,000 - \$24,999	75	\$750,000
\$5,000 - \$9,999	100	\$500,000
Less Than \$5,000	158	\$400,000
TOTAL	400	\$7,400,000

Gift Options

All members are asked to consider gifts above and beyond what they give in their regular offerings and other contributions. And there is a variety of ways that gifts can be made.

Recognize that all you have and are, are gifts from God and respond appropriately by sharing what you have in a loving and lasting way with those who seek to do His will and work. This is the essence of what it means to be a sound steward, to emulate the example and become a disciple of the ultimate steward – Jesus Christ.

Long-term subscriptions, or pledges payable over three years, are easier for most and essential to meeting our goal, since it would be impractical, if not impossible, to reach our objectives with one-time, out-of-pocket gifts. Gifts may be made in monthly, quarterly, semi-annual or annual installments at the donor's discretion. A 10% initial investment toward your total pledge is requested.

Non-cash gifts are an additional or alternative way you can support our cause. You may, for example, wish to consider gifts "in kind" such as labor and materials; gifts of securities such as stocks and bonds; gifts of real estate or even personal property such as artwork, automobiles, jewelry and antiques.

And finally, you can also choose to support our efforts through deferred gifts. These are gifts that can be given or arranged for now, but will not be received until later, and include gifts through a person's will by bequest, gifts of life insurance policies or annuities, and gifts in trust.



Gift Opportunities

There are also a number of very special gift opportunities available to donors of qualifying gift amounts. These opportunities allow people the unique chance to designate their gifts to a particular part of the project and dedicate them in honor or memory of those they choose.

Building Gifts

Gymnasium/Cafeteria	\$1,000,000
Education Center (Courtyard Building)	750,000
Education Center (Rotunda Building)	500,000

Special Sections and Selections

Education Center

Media Center	\$250,000	Parish Meeting Rooms (4)	\$30,000 ea.
Administrative Office Suite	250,000	Secretary/Receptionist Office	20,000
Education/Formation Wings (7)	200,000 ea.	Workroom	20,000
Courtyard	150,000	Courtyard Office	15,000
Art Room	100,000	Storytelling Room	15,000
Music Room	100,000	Courtyard Lobby Area	10,000
Computer lab	100,000	Rotunda Lobby Area	10,000
Science Lab	100,000	Principal's Office	10,000
Kitchen	75,000	Vice Principal's Office	10,000
Elevator	75,000	Copy Center	7,500
Courtyard Parish Meeting Room	50,000	Conference Room	7,500
Rotunda	50,000	Faith Formation Office	7,500
3 rd , 4 th , 5 th & 6 th Grade			
Classrooms (8)	50,000 ea.	<u>Gymnasium/Cafeteria</u>	
Pre-K, K, 1 st & 2 nd Grade		Sports Court	\$150,000
Classrooms (8)	30,000 ea.	Bleachers (2)	30,000 ea.
		Sound System	25,000

Prices of the stated items are not necessarily reflective of the component's cost. Rather they are based on the prominence of the item, our needs, and hopefully, the gift abilities of our community. Although payments for these gifts may be made over the entire pledge period, recognition will not be received until the gift is paid in full.

Donors of specific gift items will have their names and/or the names of those they are honoring with their gifts inscribed directly on the item given or on special plaques or nameplates placed on or near the item where appropriate. In addition, all donors, regardless of the size of their gift, will have their names listed in a special bulletin insert announcing campaign results as well as on a special "Donor Wall" or "Donor Book" that will be displayed in a prominent and visible place within our facilities.

Summary

But whatever the gift or method of making it may be, please be assured that *your* support is both urgently needed and will be greatly appreciated. Through the prayerful, volunteer and financial support of many, and the extraordinary support of a few, we will succeed in our task.

Won't you please join us in this exciting and essential effort to better our service to one another, to our community, and to Christ?

Suggested Pledge Plans (Three-Year Pledges)

Gift Level	Total Gift	(10%) Initial Investment	Daily*	Weekly*	Payment Plans			
					(36) Monthly	(12) Quarterly	(6) Semi- Annually	(3) Annually
Pacesetter	\$2,000,000	\$200,000	\$1,644	\$11,538	\$50,000	\$150,000	\$300,000	\$600,000
	1,000,000	100,000	822	5,769	25,000	75,000	150,000	300,000
	750,000	75,000	616	4,327	18,750	56,250	112,500	225,000
	500,000	50,000	411	2,885	12,500	37,500	75,000	150,000
	250,000	25,000	206	1,442	6,250	18,750	37,500	75,000
	100,000	10,000	82	577	2,500	7,500	15,000	30,000
	75,000	7,500	62	433	1,875	5,625	11,250	22,500
	50,000	5,000	41	288	1,250	3,750	7,500	15,000
	40,000	4,000	33	231	1,000	3,000	6,000	12,000
	30,000	3,000	25	173	750	2,250	4,500	9,000
25,000	2,500	21	144	625	1,875	3,750	7,500	
Major	20,000	2,000	16.44	115	500	1,500	3,000	6,000
	15,000	1,500	12.33	87	375	1,125	2,250	4,500
	10,000	1,000	8.22	58	250	750	1,500	3,000
	5,000	500	4.11	29	125	375	750	1,500
Community	4,000	400	3.29	23	100	300	600	1,200
	3,000	300	2.47	17	75	225	450	900
	2,000	200	1.64	12	50	150	300	600

* These figures are provided for illustration purposes only. To minimize costs, suggested payment plans include monthly, quarterly, semi-annual or annual installments.

*“As each one has received a gift, use it to serve one another
as good stewards of God’s varied grace.”*

1 Peter 4:10