

BUILDING IN THE SPIRIT

PHASE ONE—PART A

Part A consists of building the whole Phase One infrastructure including all roads, parking (all in gray), landscaping, etc., and constructing a 2-story, 21-classroom building for use as a Parish Religious Education facility and PreK-6 School (in green) with Part B & C to be built as soon as possible.

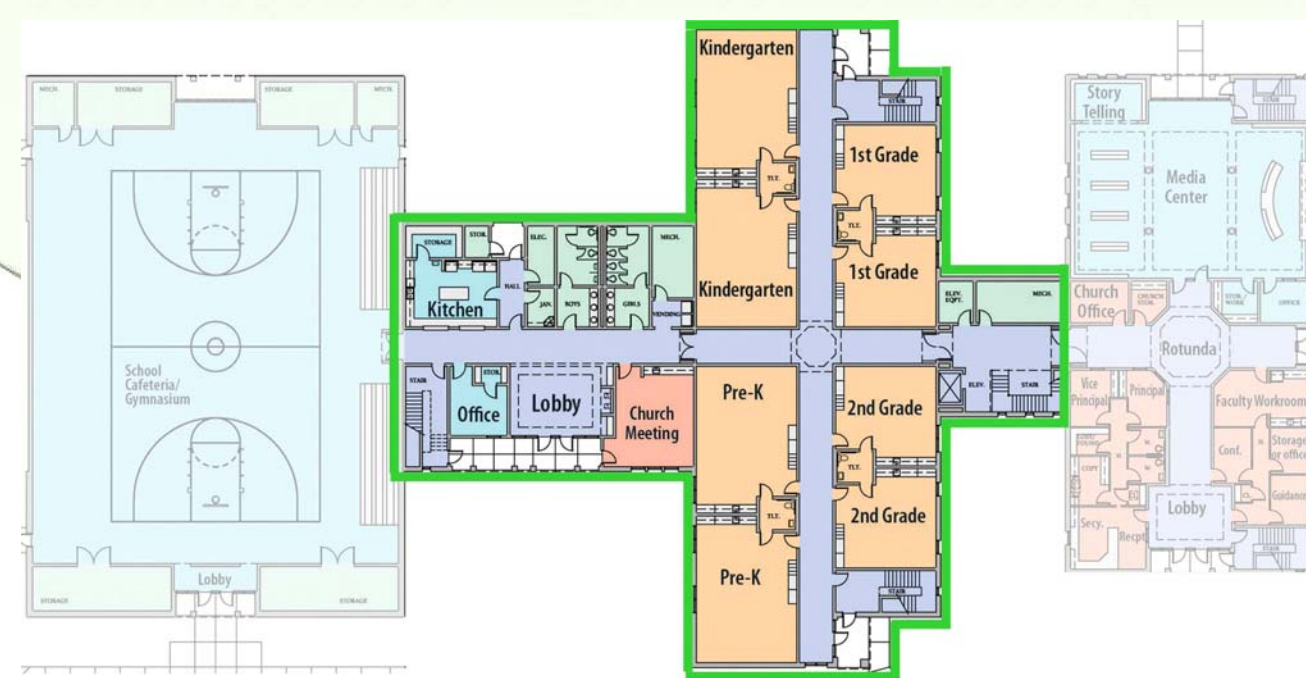
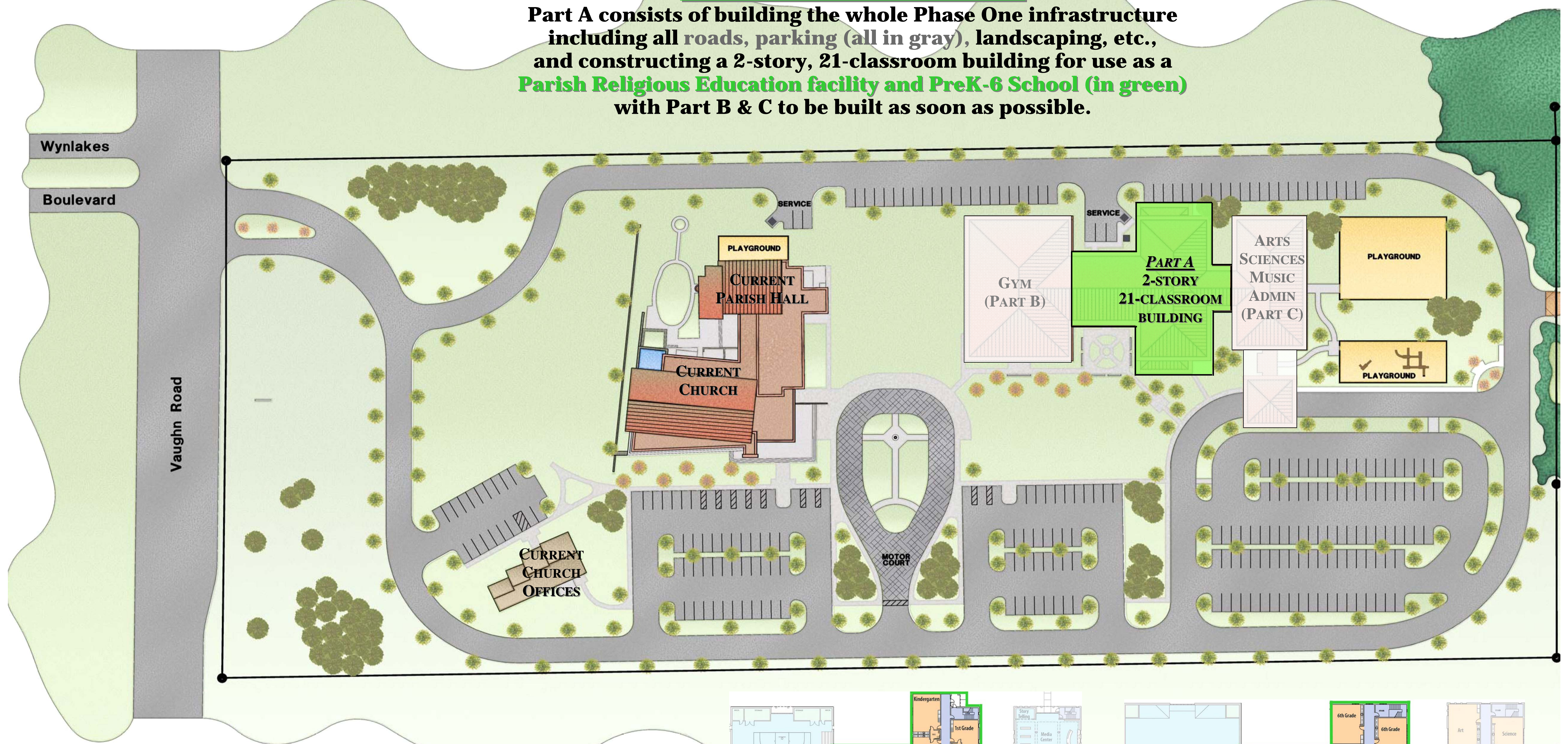

First Floor Layout of Classroom Bldg.

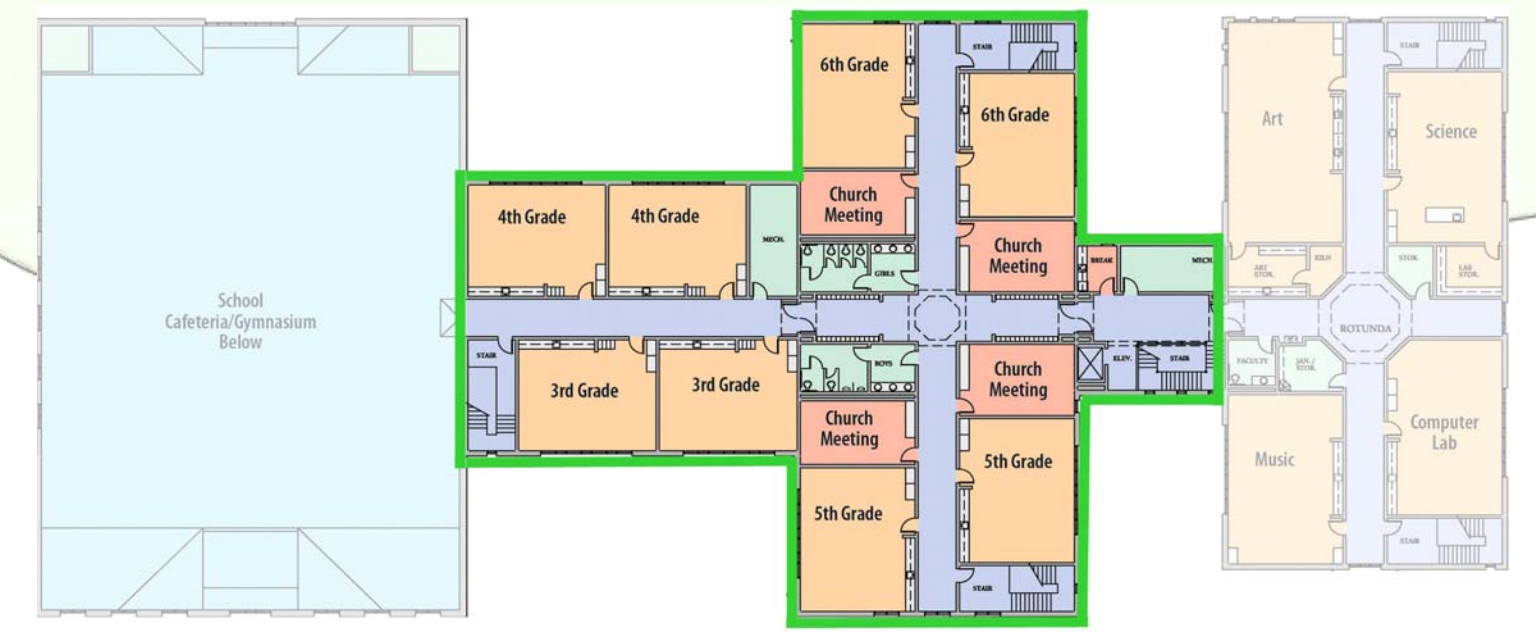

Second Floor Layout of Classroom Bldg.